

TARAbase

CL4

free chlorine

membrane-covered sensor

Special features

- short response time
- easy handling

Applications

swimming-pool, drinking, service and process water

Process conditions

- stable pH value
- no surfactants in the measuring water
- max. temperature: 45 °C
- max. pressure: 1 bar

CL2

free chlorine

membrane-covered sensor

Special features

- suitable for high salt concentrations
- short response time
- easy handling

Applications

Brine and sea-water applications

Process conditions

- stable pH value
- no surfactants in the measuring water
- max. temperature: 45 °C
- max. pressure: 1 bar
- 3.5% to 26% salt content in the measuring water

CONTACT



Reiss GmbH

Eisleber Str. 5
D – 69469 Weinheim

Fon +49 (0) 6201/25939-0
Fax +49 (0) 6201/25939-10

Email: info@reiss-gmbh.com
www.reiss-gmbh.com

 **Reiss GmbH**
we create sensor solutions

OUR PRODUCTS

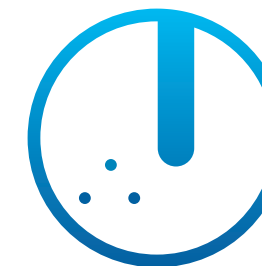

Sensors

The sensors measure various disinfectants dissolved in water in diverse applications (swimming pools, drinking water, service water, CIP systems, cooling and waste water etc.). They are offered with various measuring ranges and output signals. We also supply customised versions of our sensors upon request. Our range of products currently includes the brands described below. They feature a variety of performance profiles and thus can be used for a wide range of applications*:

TARAbase, TARAline, TARatec & TARAsens

The sensors are subdivided into two groups: Membrane-covered sensors and non-membrane-covered sensors. This also allows their use in special applications in areas with high pressures, temperatures and concentrations of the disinfectant.

TARAbase



TARAline



TARatec

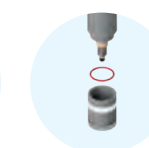

TARAsens

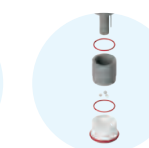

* You can find more detailed information about our sensors in our product flyer "Sensors" or on our website.

CHLORINE SENSORS

TARAline

CC1

free chlorine in the presence of cyanuric acid
membrane-covered sensor

- Special features**
- reduced dependence on pH
 - tolerates surfactants
 - requires little maintenance
 - tolerates low conductivity

Applications
Swimming-pool, drinking, service, process and sea water

- Process conditions**
- max. temperature: 45 °C
 - max. pressure: 3 bar
 - min. conductivity: 10 µS/cm

CS4

free chlorine
membrane-covered sensor

- Special features**
- reduced dependence on pH
 - tolerates surfactants
 - requires little maintenance
 - tolerates low conductivity

Applications
Swimming-pool, drinking, service, process and sea water

- Process conditions**
- max. temperature: 45 °C
 - max. pressure: 3 bar
 - min. conductivity: 10 µS/cm

CP4

total chlorine
membrane-covered sensor

- Special features**
- reduced dependence on pH
 - tolerates surfactants
 - requires little maintenance
 - tolerates low conductivity

Applications
Swimming-pool, drinking, service, process, sea & brine water

- Process conditions**
- max. temperature: 45 °C
 - max. pressure: 3 bar
 - min. conductivity: 10 µS/cm

CP4MA*-AT

total chlorine
membrane-covered sensor

- Special features**
- tested according to ATEX and IECEx
 - tolerates surfactants
 - reduced dependence on pH
 - requires little maintenance

Applications
Sea and ballast water

- Process conditions**
- max. temperature: 45 °C
 - max. pressure: 0.5 bar

TARAsens

AS2-CL

free chlorine
non-membrane-covered sensor

- Special features**
- suitable for high pressures
 - short response time
 - tolerates surfactants
 - reduced maintenance due to automatic electrode cleaning with RV1 (optional)

Applications
Drinking water

- Process conditions**
- stable pH value
 - max. temperature: 50 °C
 - max. pressure: 8 bar

AS3-CL

free chlorine
non-membrane-covered sensor

- Special features**
- suitable for high water temperatures
 - suitable for high pressures
 - short response time
 - tolerates surfactants
 - reduced maintenance due to automatic electrode cleaning with RV1 (optional)

Applications
Drinking water, hot water applications

- Process conditions**
- stable pH value
 - max. temperature: 70 °C
 - max. pressure: 8 bar

TARAtec

CH10

free chlorine
membrane-covered sensor

- Special features**
- suitable for high chlorine concentrations of up to 2000 ppm
 - mechanically robust membrane system
 - tolerates surfactants
 - high tolerance to chemicals
 - tolerates polluted measuring water

Applications
Washing of fruit, vegetables and poultry, service and process water

- Process conditions**
- stable pH value
 - max. temperature: 45 °C
 - max. pressure: 1 bar

We also offer sensors for the following disinfectants:

• Chlorine dioxide	• Ozone	• Bromine
• Peracetic acid	• Hydrogen peroxide	• Chlorite